

QUICK START GUIDE FOR INDUSTRIAL FAN INSTALLATION

STEP #1 STEEL BEAM INSTALLATION

ALTERNATE MOUNTING - MANUAL PAGES 7-9

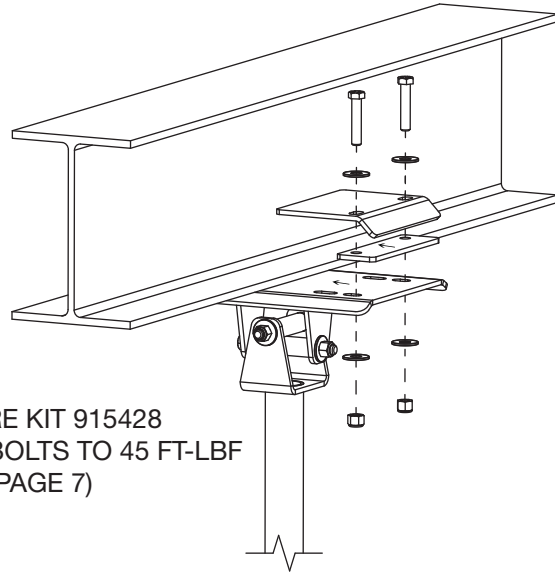

HARDWARE KIT 915428
TORQUE BOLTS TO 45 FT-LBF
(MANUAL PAGE 7)

- REFER TO INSTALLATION MANUAL FOR COMPLETE INSTALLATION INFORMATION
- THIS QUICK START GUIDE DOES NOT REPLACE INSTALLATION MANUAL INSTRUCTIONS

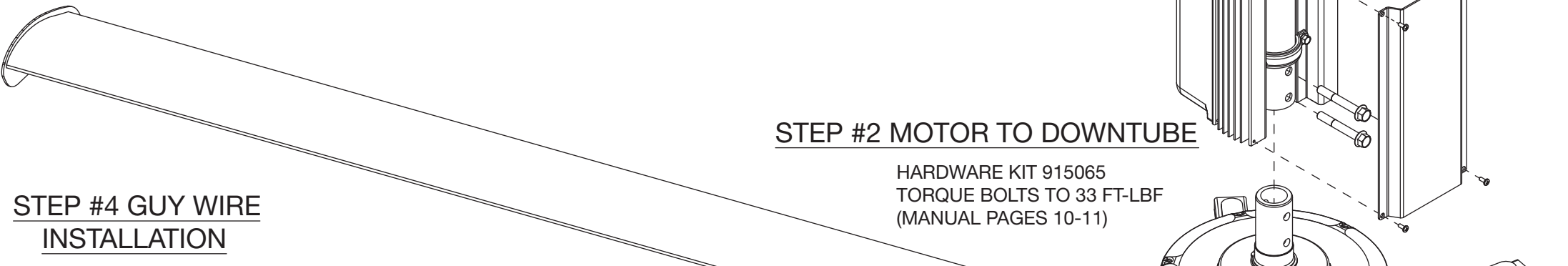

STEP #2 MOTOR TO DOWNTUBE

HARDWARE KIT 915065
TORQUE BOLTS TO 33 FT-LBF
(MANUAL PAGES 10-11)

STEP #3 SAFETY CABLE INSTALLATION

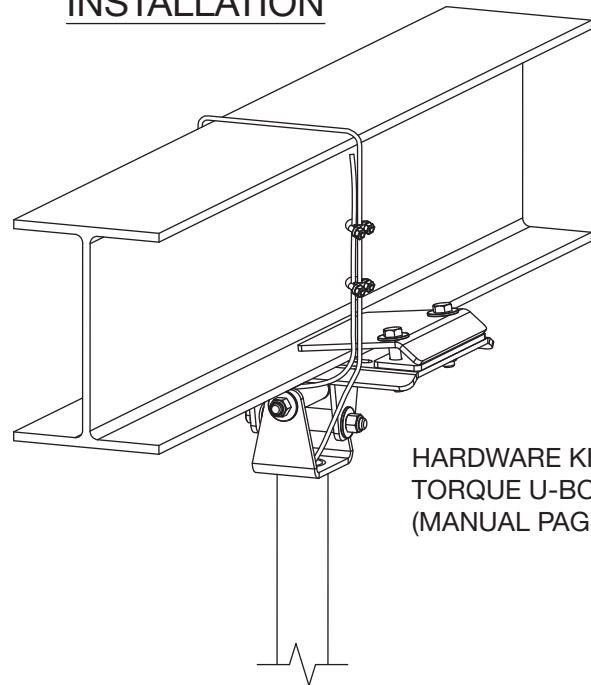

HARDWARE KIT 916290
TORQUE U-BOLTS TO 54 IN-LBF
(MANUAL PAGE 12-13)

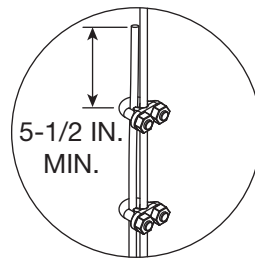

STEP #4 GUY WIRE INSTALLATION

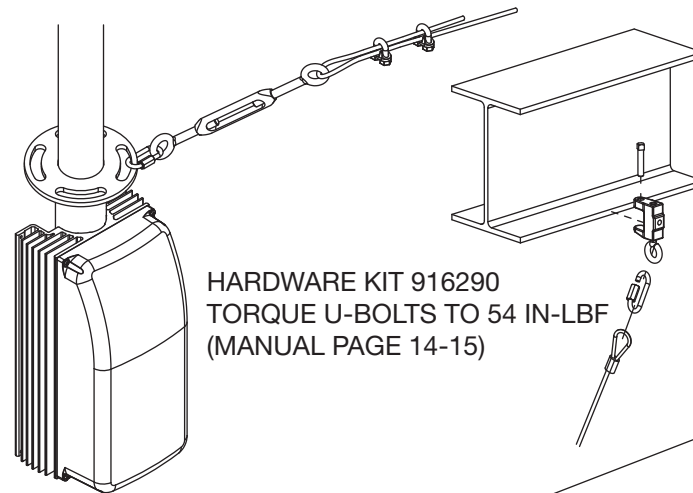

HARDWARE KIT 916290
TORQUE U-BOLTS TO 54 IN-LBF
(MANUAL PAGE 14-15)

STEP #6 AIRFOIL INSTALLATION

HARDWARE KIT 854832 OR 915066
TORQUE TO 25 FT-LBF
(MANUAL PAGE 15-16)

STEP #5 WINGLET INSTALLATION

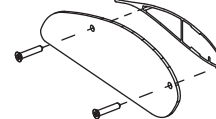

HARDWARE KIT 854832 OR 915066
TORQUE SCREWS TO 60 IN-LBF
(MANUAL PAGE 15-16)

TOOL LIST:

- IMPACT DRIVER
- 7/16 IN., 1/2 IN., 9/16 IN. AND 3/4 IN. SOCKETS
- 1/2 IN. AND 3/4 IN. WRENCHES
- #2 PHILLIPS SCREWDRIVER
- #2 PHILLIPS IMPACT BIT
- MAGNETIC TORPEDO LEVEL
- TORQUE WRENCH (UP TO 50 FT-LBF)
- TORQUE WRENCH (UP TO 120 IN-LBF)

STEP #7 HUB PLATE INSTALLATION

OPTIONAL LED LIGHT INSTALLATION - MANUAL PAGE 15

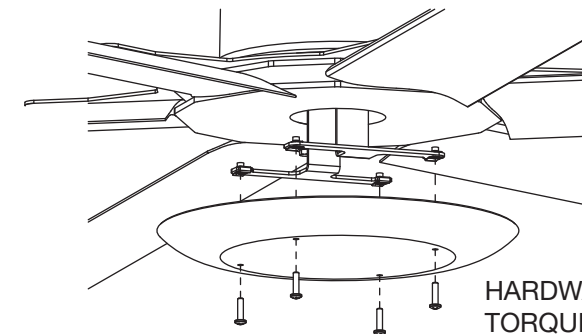

HARDWARE KIT 854832 OR 915066
TORQUE SCREWS TO 96 IN-LBF
(MANUAL PAGE 17)

FAN NETWORKING

FOR ALL WIRING AND NETWORKING - SEE MANUAL PAGES 11-12 AND 18-20

HELPFUL HINT

ALL NETWORKING MODIFICATIONS CAN BE COMPLETED PRIOR TO BLADE INSTALLATION.

MOTOR-TO-VFD WIRING AND DIP SWITCH BANK LOCATIONS

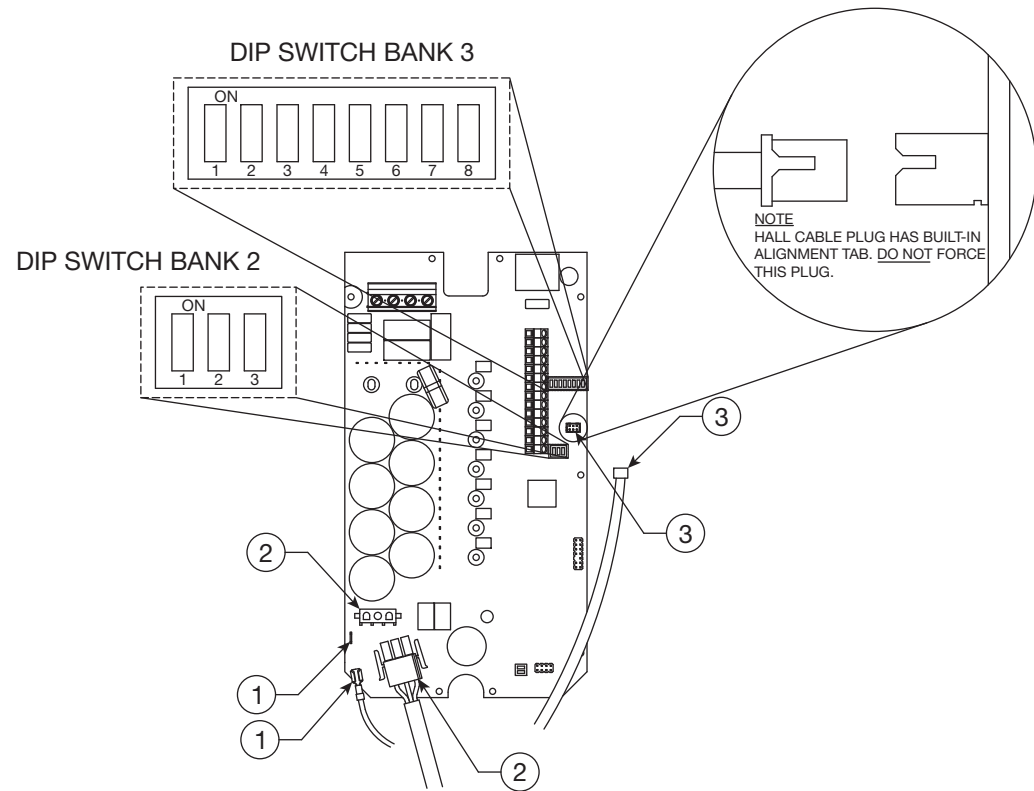

DIP SWITCH BANK 2 SETTINGS

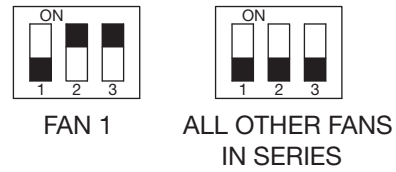

DIP SWITCH BANK 3 SETTINGS (MODBUS ADDRESSES)

MODBUS ADDRESS	SWITCH 1	SWITCH 2	SWITCH 3	SWITCH 4	SWITCH 5	SWITCH 6, 7, 8
2	ON	OFF	OFF	OFF	OFF	DO NOT MODIFY
3	OFF	ON	OFF	OFF	OFF	
4	ON	ON	OFF	OFF	OFF	
5	OFF	OFF	ON	OFF	OFF	
6	ON	OFF	ON	OFF	OFF	
7	OFF	ON	ON	OFF	OFF	
8	ON	ON	ON	OFF	OFF	
9	OFF	OFF	OFF	ON	OFF	
10	ON	OFF	OFF	ON	OFF	
11	OFF	ON	OFF	ON	OFF	

ALL OTHER FANS IN SERIES

- REMOVE BROWN/WHITE 24V WIRE AND CAP
- DO NOT REMOVE BROWN GROUND WIRE
- REMOVE SILVER SHIELD AND SECURE IN A WAY THAT PREVENTS CONTACT WITH VFD BOARD

FIRST FAN IN SERIES

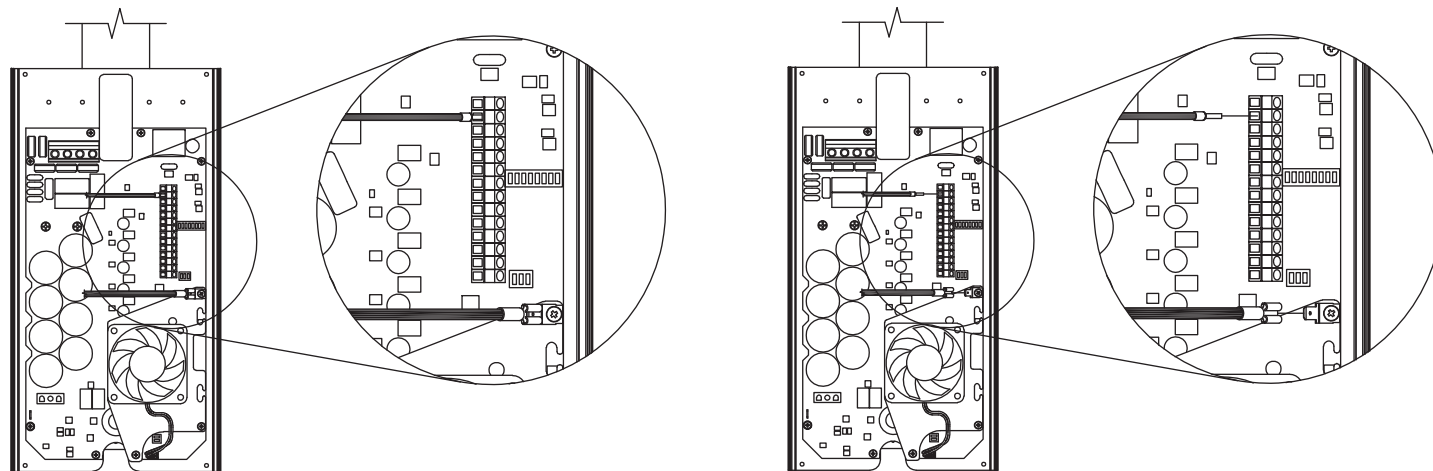

FIRE RELAY INSTALLATION AND WIRING

20 TO 32 VDC

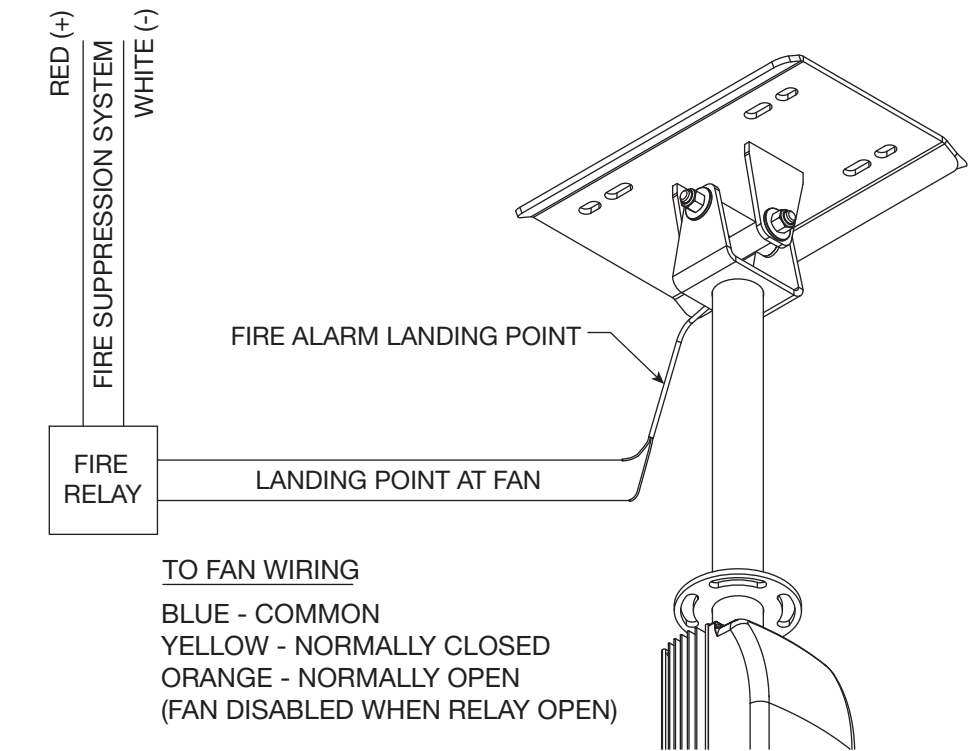

NOTE

DO NOT CUT CABLE OR REMOVE CRIMP CAP IF NOT USING FIRE RELAY.

POST INSTALLATION CHECKLIST

- ALL BOLTS TIGHTENED PROPERLY
- ONLY USED SHIELDED NETWORKING COMPONENTS PROVIDED
- MODBUS ADDRESSES SET
- SAFETY CABLE INSTALLED PROPERLY
- VERIFY POWER AND NETWORKING CABLES CONNECTED